

Sizing Saw Blades HW „Matador 5“

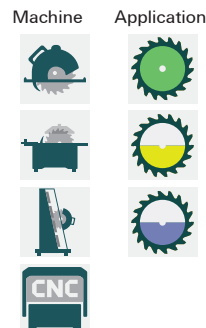
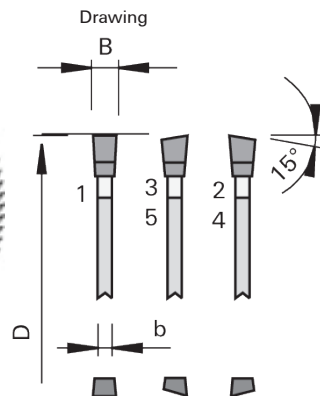

ADVANTAGES

- ✓ excellent cutting quality for cross cuts
- ✓ chip-free grooving, thanks to special tooth geometry
- ✓ extremely long edge lives
- ✓ noise-reduction thanks to laser ornaments

Machine / Application

- table-, clipping and miter saws
- CNC machining centers and aggregates
- for chip-free sizing cuts clipping and miter cuts in woodbased panels, solid woods and plastics

Design

- special group tooth configuration and carbid tips

catalog page 1-24

Ø D [mm]	B [mm]	b [mm]	Ø d [mm]	Z	Cutting quality*	NL**	Hook angle [°]	Order-No.
180	3,0	2,2	30	60	▲▲▲▲	4/ 6/ 52	15	58808701
200	3,0	2,2	30	65	▲▲▲▲		15	58808702
220	3,0	2,2	40	70	▲▲▲▲	8/ 6/ 52	15	58808703
240	3,0	2,2	30	75	▲▲▲▲	8/ 6/ 52	15	58808704
250	3,0	2,2	30	80	▲▲▲▲	Combi3	15	58808706
300	3,0	2,2	30	100	▲▲▲▲	Combi3	15	58808708
300	4,0	3,2	30	100	▲▲▲▲	Combi3	15	58808713
350	3,0	2,2	30	100	▲▲▲▲	Combi3	15	58808709

Rear Board Grooving Cutter HW, "RNK-Matador 5"

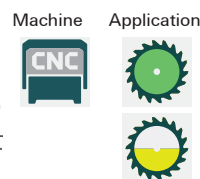
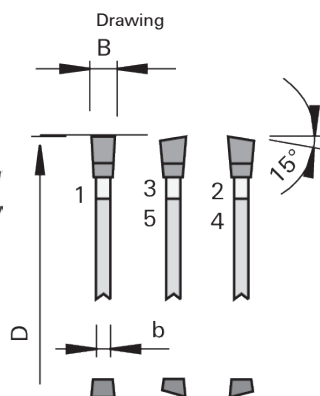

ADVANTAGES

- ✓ excellent cutting quality
- ✓ low noise level
- ✓ long edge lives thanks to highly wear-resistant cutting material

Machine / Application / Design

- Homag (Weeke BHX series)
- CNC machining centers and aggregates
- for chip-free grooving in solid woods, raw and laminated wood-based panels and plastics
- special group tooth configuration and carbid tips

catalog page 2-6

Ø D [mm]	B [mm]	b [mm]	Ø d [mm]	Z	Cutting quality*	NL**	Hook angle [°]	Order-No.
120	4,0	2,8	20	35	▲▲▲		15	HOLZ-HER 50806258
120	5,0	4,0	20	35	▲▲▲		15	HOLZ-HER 50806259
120	4,0	2,8	20	35	▲▲▲	2x3/4,5/35	15	SCM /Morbidelli 50806254
120	5,0	4,0	20	35	▲▲▲	2x3/4,5/35	15	SCM /Morbidelli 50806255
120	4,0	2,8	35	35	▲▲▲	2x4/6,3/50	15	Biesse 50806256
120	5,0	4,0	35	35	▲▲▲	2x4/6,3/50	15	Biesse 50806257
125	4,0	2,8	30	35	▲▲▲	2x4/5,5/48	15	Homag (Weeke BHX) 50806251
125	5,0	4,0	30	35	▲▲▲	2x4/5,5/48	15	Homag (Weeke BHX) 50806253

*▲ = very rough cut, ▲▲ = rough cut, ▲▲▲ = fine cut, ▲▲▲▲ = very fine cut, Combi3 = 2/10/60, 2/9/46, 2/9,5/46,5 and 2/7/42

2257-2 VHW Finishing Cutters two-sided shear angle

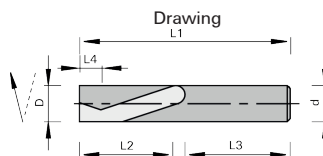

Machine



Application



ADVANTAGES

- ✓ optimum cutting quality in laminated panels thanks to shear angle

Machine / Application

- CNC routers
- for finish cutting in solid woods and plastic
- for cutting of cut-outs and contours
- traveling plunge cut using Z - X - Y - axis

Design

- full-carbide body
- shear angle

Notes

- clamping elements: ps-System with intermediate sleeves, TRIBOS, draw-in collet chuck
- n max = 30.000 min-1

catalog page 3-10

Ø D [mm]	L4 [mm]	L2 [mm]	Ø d [mm]	L1 [mm]	Z	Order-No.
16	24	55	16	110	3	50811567

2254 VHW Lock-Case Roughing Cutters - for door manufacturing

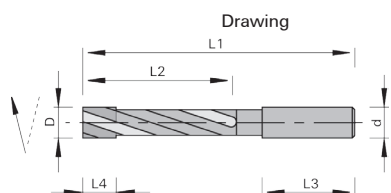

Machine



Application



ADVANTAGES

- ✓ optimum chip evacuation thanks to positive spiral
- ✓ high balance quality

Machine / Application

- CNC machining centers
- for cutting of lock-cases in doors

Design

- full-carbide body
- cutting edges with chip breakers

Notes

- clamping elements: ps-System with intermediate sleeves, TRIBOS, draw-in collet chuck
- Attention: For horizontal boring-cutting aggregat (e.g. Homag, Weeke) side clamping surfaces necessary.

catalog page 3-12

Ø D [mm]	L4 [mm]	L2 [mm]	Ø d [mm]	L3 [mm]	L1 [mm]	Z	Order-No.
16	25	115	16	50	175	3	50811926

2255 VHW Lock-Case Finishing Cutterst - for door manufacturing

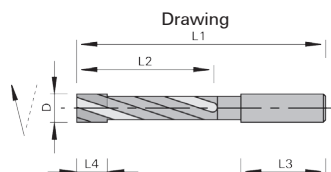

Machine



Application



ADVANTAGES

- ✓ optimum chip evacuation thanks to positive spiral
- ✓ high balance quality
- ✓ serrated cutting edge with chip breakers

Machine / Application

- CNC machining centers
- for cutting of lock-cases and face-plates in doors

Design

- full-carbide body
- cutting edges with chip breakers

Notes

- clamping elements: ps-System with interm. sleeves, TRIBOS, draw-in collet chuck
- Attention: For horizontal boring-cutting aggregat (e.g. Homag, Weeke) side clamping surfaces necessary.

catalog page 3-12

Ø D [mm]	L4 [mm]	L2 [mm]	Ø d [mm]	L3 [mm]	L1 [mm]	Z	Order-No.
16	25	115	16	50	175	3	50811929

3502 DP Shank-Type Cutters Z=1+1

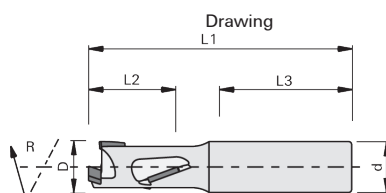

Machine



Application



ADVANTAGES

- ✓ optimum cutting quality thanks to larger shear angle, alternating top and bottom
- ✓ smooth running thanks to special tool body
- ✓ chip-free grooving possible from groove depths of 4.5 mm
- ✓ DP plunge tip for diagonal plunge-cutting
- ✓ resharpenable several times

Machine / Application

- CNC routers
- for jointing, rabbeting, grooving and copying in raw-, melamine-, paper-, HPL-laminated-, foiled- and veneered panels

Desing

- DP plunge tip for diagonal plunge-cuts
- resharpenable up to 3 times

catalog page 3-14

Ø D [mm]	L2 [mm]	Ø d [mm]	L3 [mm]	L1 [mm]	Z	Order-No. [L]	Order-No. [R]
18	43	20	55	110	1+1	58186808	58186807
20	52	25	55	120	1+1	58186811	58186810

3503 DP High-Performance Shank-Type Cutters Z=2+2

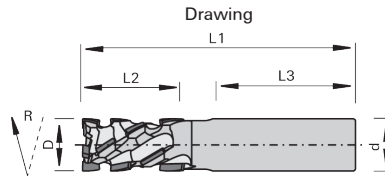

Machine



Application



ADVANTAGES

- ✓ optimum cutting quality thanks to shear angle, alternating top and bottom
- ✓ cutting edges in 4-wings design for smooth running
- ✓ very long edge lives, less cutting forces and less noise thanks to optimized tool body

Machine / Application

- CNC routers
- for jointing, rabbeting, grooving and copying in raw-, melamine-, paper-, HPL-laminated, foiled- and veneered panels

Design

- with DP plunge tip for diagonal plunge-cutting
- with shear angle
- resharpening area 1,2 mm

catalog page 3-17

Ø D [mm]	L2 [mm]	Ø d [mm]	L3 [mm]	L1 [mm]	Z	Order-No. [L]	Order-No. [R]
20	28	25	55	95	2+2	50186152	50186151
25	65	25	55	130	2+2	50186160	50188159

3510 DP Roughing Cutters Z=2+2

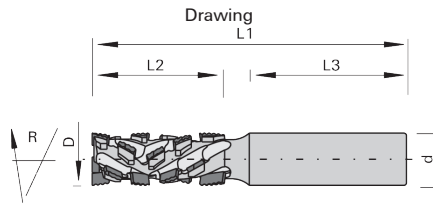
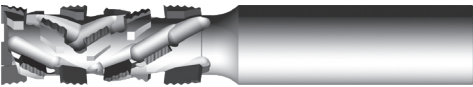

Machine



Application



ADVANTAGES

- ✓ long edge lives also in abrasive materials
- ✓ chip-free cutting edges on both sides
- ✓ high milling performance

Notes

- slightly rough cutting surface due to fine cut division

Machine / Application

- CNC routers
- for sizing in roughing quality
- for solid and ply wood, laminated wood-based materials and other abrasive materials (e.g. GFRP, HPL-compact boards, sandwich panels)
- for cutting of cut-outs and contours
- traveling plunge cut using Z - X - Y axis

Design

- with alternating shear angle
- with DP plunge tip
- face cutting for diagonal plunge-cutting
- resharpening area ≥ 2.0 mm

catalog page 3-15

Ø D [mm]	L2 [mm]	Ø d [mm]	L3 [mm]	L1 [mm]	Z	Order-No.
20	50	20	60	120	2+2	50811808

3511 DP High-Performance Roughing Shank-Type Cutters for solid core panels

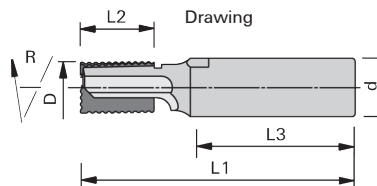

Machine



Application



ADVANTAGES

- ✓ rough and finish cut
- ✓ long edge lives
- ✓ face edge for diagonal plunge-cut

Machine / Application

- CNC routers
- for pre-sizing in wood-based materials and solid wood
- especially for plastic solid core panels (e.g. Trespa, Corian, Varicor, LG-HiMacs, etc.)

Design

- alternating shear angle
- DP plunge tip to use z, x, y axis

catalog page 3-15

Ø D [mm]	L2 [mm]	Ø d [mm]	L3 [mm]	L1 [mm]	Z	Order-No.
14	20	16	45	75	2+1	50811809

3514 DP Roughing-finishing cutters „Z=2+2“

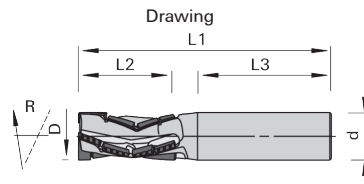

Machine



Application



ADVANTAGES

- ✓ long edge lives also in abrasive materials
- ✓ chip-free cutting edges on both sides
- ✓ high hogging volume

Machine / Application

- CNC routers
- for sizing in almost finishing quality in solid woods and plywood, laminated wood-based panels and sandwich materials
- for cutting of cut-outs and contours
- traveling plunge cut using Z and X or Y axis

Design

- alternating shear angle
- DP plunge tip
- face cutting for diagonal plunge-cutting

catalog page 3-16

Ø D [mm]	L2 [mm]	Ø d [mm]	L3 [mm]	L1 [mm]	Z	L/R	Order-No.
16	32	16	45	85	4(2+2)	R	58811950

3513 DP High-Performance Shank-Type Cutters CM for Nesting „Z=2+2“

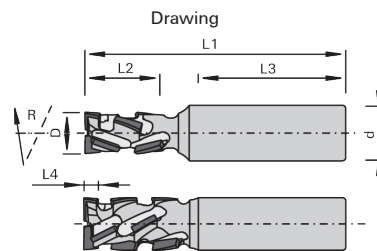
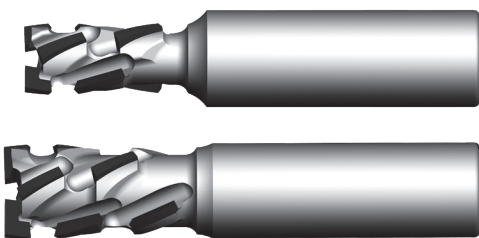

Machine



Application



ADVANTAGES

- ✓ high cutting quality on both sides thanks to specially adapted arrangement of cutting edges
- ✓ positive spiral: optimum upward chip evacuation towards the dust extraction
- ✓ negative spiral: downward chip evacuation and cutting pressure
- ✓ thread for length adjusting screw
- ✓ higher feed rate and thicker boards requires higher diameter (D)
- ✓ adapt the cutting length to the panel thickness (H)
- ✓ with DP plunge tip
- ✓ face cutting for diagonal plunge-cutting

Machine / Application

- CNC routers
- for panel sizing with Nesting Technology
- for jointing, rabbeting and *grooving (*negative design)
- particularly for processing MDF panels and Multiplex
- negativ spiral: for small or narrow workpieces and grooving
- Z=2+2 = bigger gullets for optimized chip removal (MDF) and for reducing heat generation (e.g. Multiplex).

Design

- DP plunge tip
- face cutting for diagonal plunge-cutting

catalog page 3-19

Ø D [mm]	L2 [mm]	L4 [mm]	Ø d [mm]	L3 [mm]	L1 [mm]	Z	H [mm]	Helical direction	Order-No.
12	22	4,5	16	45	75	2+2	16-19*	positive	58186112
16	28	4,5	16	45	80	2+2	-25	negative	58186114

3506 DP High-Performance Shank-Type Cutters for Nesting „Z=3+3“

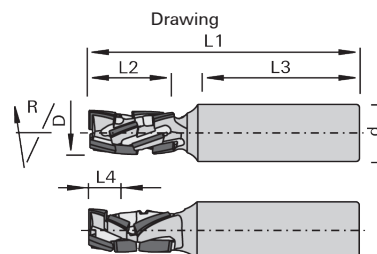
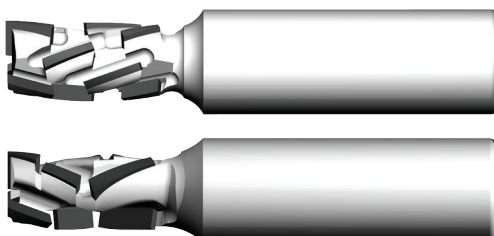

Machine



Application



ADVANTAGES

- ✓ high cutting quality and high-quality cutting edges thanks to specially adapted cutting edge configuration
- ✓ positive spiral: optimum upward chip evacuation towards the exhaustion

Machine / Application

- CNC routers
- for panel sizing with Nesting Technology
- for jointing, rabbeting and *grooving (*negative version) in raw and laminated wood-based materials

Design

- DP plunge tip
- face cutting for diagonal plunge-cutting

Notes

- with thread for length adjusting screw
- higher feed rate and thicker boards requires higher diameter (D)
- adapt cutting length to panel thickness (H)
- * indicate "H" in case of Nesting with protection board

catalog page 3-20

Ø D [mm]	L2 [mm]	L4 [mm]	Ø d [mm]	L3 [mm]	L1 [mm]	Z	H [mm]	Helical direction	Order-No.
12	28		16	45	80	3+3	22-25*	positive	58186572
16	28		16	45	80	2+2	22-25*	positive	58186574

3507 DP High-Performance Trimming Router Bits

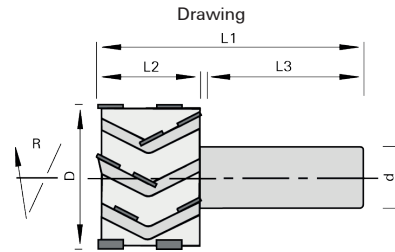

Machine



Application



ADVANTAGES

- ✓ high feed rates (up to 35 m/min) and good edge quality thanks to 4 cutting edges working in top layer
- ✓ minimized dust formation thanks to 2 cutting edges working in core of board
- ✓ very good surface thanks to large cutting circle diameter
- ✓ good cutting quality on top and bottom edge thanks to opposing shear angle
- ✓ preferably for finish-cut operations on pre-sized workpieces

Machine / Application

- CNC routers
- for sizing cuts in raw-, melamine-, paper-, HPL-laminated-, foiled- and veneered panels

Design

- high-performance tool
- for finish cuts
- with shear angle
- resharpening area 3.0 mm

catalog page 3-21

Ø D [mm]	L2 [mm]	Ø d [mm]	L3 [mm]	L1 [mm]	Z	H [mm]	Order-No.
48	28	25	62	91	4+2+4	22-25	58186142

3620 DP p-System High-Performance Grooving Shank-Type Cutters

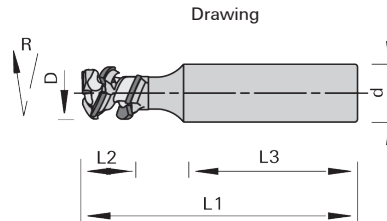
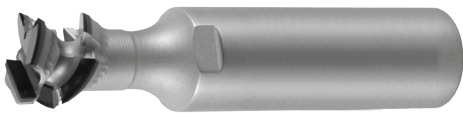

Machine



Application



ADVANTAGES

- ✓ maximum cutting quality and edge live
- ✓ chip-free cuts even on the exit side
- ✓ extremely scoring cut

Design/Notes

- minimal grooving depth 0.5 mm
- from D=25mm Z=2 possible, plunge edge will be always Z=1
- convex bottom cutting edge for high quality of rabbet, however corner of rabbet not absolutely sharp
- for ramping or circular plunging only

Machine / Application

- CNC stationary machines
- for grooves, cut outs, pockets and as forend cutter
- for high-performance grooving of solid woods (free of knots) along and across the grain
- for high-performance grooving of melamine-, paper-, HPL-laminated, foiled and veneered panels and lacquered surfaces
- finish-quality in the case of fiber materials such as fabric-laminated panels, linoleum with jute fibers, cork etc.

catalog page 3-24

Ø D [mm]	L2 [mm]	Ø d [mm]	L3 [mm]	L1 [mm]	Z	Shear \angle	Order-No.
18	19	20	55	84	1+1	70°	58185614

5572 HW Planing and Rabbeting Shank-Type Cutterhead

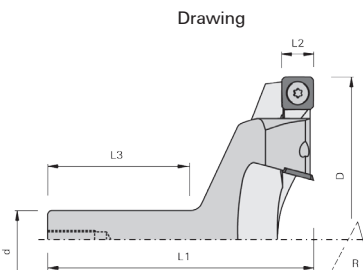
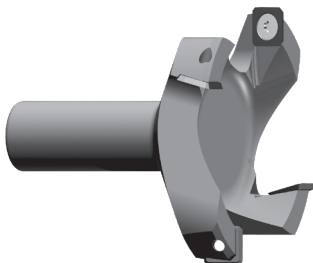

Machine



Anwendung



ADVANTAGES

- ✓ high milling performance when dressing the workbench boards, e.g. Nesting Technology
- ✓ smooth surface thanks to special cutting edge geometry
- ✓ with thread for length adjusting screw

Machine / Application

- CNC routers
- for planing, rabbeting and panel raising in wood-based materials

Design

- cutting material: TC25
- 4 exchangeable turnover knives

catalog page 3-26

Ø D [mm]	L2 [mm]	Ø d [mm]	L3 [mm]	L1 [mm]	Z	Order-No.
100	14	25	55	96	4	50811806

5575 Spiral Cutterheads

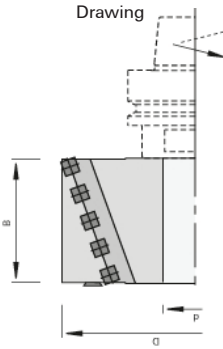

Machine



Application



ADVANTAGES

- ✓ easy hogging, low cutting pressure and low noise level
- ✓ high hogging volume

Machine / Application

- stationary milling centers
- for dressing, rough-planing, jointing, rabbeting, copying of solid woods and laminated timber

Design

- four-sided turnover knives, with rounded edges
- 2 front spurs HW
- for HSK mounting arbors with double key without spacer

catalog page 3-27

Ø D [mm]	B [mm]	Ø d [mm]	Z	nmX [min-1]	Order-No.
80	80	30	2+2+v2	18000	58665 105
80	100	30	2+2+v2	18000	58665 106

HSK63 - mounting arbors

63 HSK 63F 30 50 45 18 8 x 3	183748
63 HSK 63F 30 80 45 18 8 x 3	183749

5576 Jointing and rabbeting cutterheads mounted on mounting arbor HSK63F

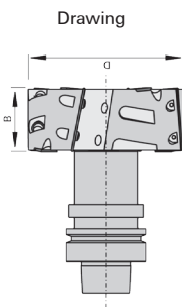
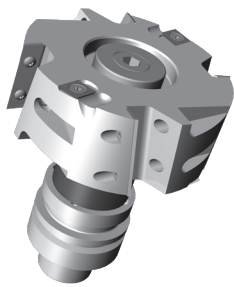

Machine



Application



ADVANTAGES

- ✓ optimum cutting quality

Design

- with alternating shear angles for pulling cut
- with 2 upper and 2 lower spurs each
- mounted on mounting arbor HSK63F including spacer

Machine / Application

- CNC milling machines
- for chip-free grooving and rabbeting in solid wood and wood-based materials
- for laminated-, uncoated- and glued solid wood and strongly wearing wood

catalog page 3-28

Ø D [mm]	B [mm]	Ø d [mm]	Z	DKN [mm]	nmX [min-1]	Order-No.
125	50	30	2+2+V2+2	8x3	10600	58665 108

1593 V Groove Letter Cutters

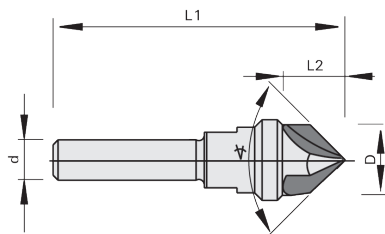

Machine



Application



Machine / Application

- portable routers, CNC machines
- for "V" and ornamental grooves, letters and chamfering of hard-, and wood-based materials
- for countersinking of bores

Design

- solid carbide cutters with 3 HW cutting edges
- clock-wise rotation
- MAN / MEC feed

catalog page 3-33

Ø D [mm]	L2 [mm]	Ø d [mm]	L3 [mm]	∠ [°]	L1 [mm]	Z	Order-No.
14	12,5	12	25	120	62,5	3	50811813

1523 Rounding Chamfering Cutterheads Set Z=2

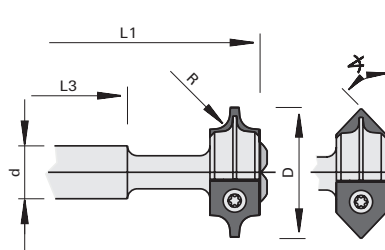

Machine



Application



Machine / Application

- CNC machines
- for rounding of one or both sides and chamfering of panel materials

Design

- tool body with exchangeable HW profile knives
- direction: clockwise (cw)
- mechanical feed

catalog page 3-34

Ø D [mm]	L2 [mm]	Ø d [mm]	L3 [mm]	L1 [mm]	Z	Type	Order-No.
21	6	16	60	100	2	Set 1	50811820
1 body size 1 2 pieces of each rounding knife R2 / R3 / R4 / R5 2 chamfering knives 45°							
47,8	9	20	55	120	2	Set 2	50811821
1 body size 2 2 pieces of each rounding knife R6 / R8 / R10 / R12 2 chamfering knives 45°							

3519 VHW Shank-Type Cutter for Lamello Clamex P®

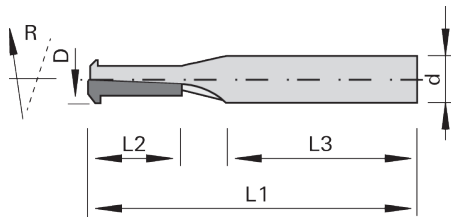

Application

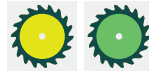

ADVANTAGES

- ✓ high rigidity = low vibration even with difficult materials
- ✓ low cutting pressure and high cutting quality thanks to spiral design Z=2
- ✓ low friction & long edge life thanks to special coating

Machine / Application

- 5-axis CNC machines
- for the milling of Lamello Clamex P® profile grooves
- for profil grooves at the panel surface - away from the panel edge additionally as alternative to clamex grooving cutter with bore (Type 3104L, # 50660346)

Design

- full carbide body
- TC 104 topcoat coating
- disposable tool
- not resharpenable

catalog page 3-36

Ø D [mm]	L2 [mm]	Ø d [mm]	L3 [mm]	L1 [mm]	Z	Order-No.
9,8	23	12	36	80	2	58186879

2022 VHW Through-Hole Bits



Drawing

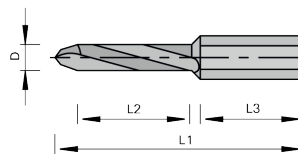

Machine



Application



ADVANTAGES

- ✓ chip-free hole edges thanks to special edge geometry
- ✓ high process safety through constant quality
- ✓ high feed rates
- ✓ up to 6-times longer edge-life (compared to traditional ones)
- ✓ solide carbide body

Machine / Application

- portable boring machines
- automatic boring machines
- CNC machining centers
- for chip-free drilling of through-holes in solid woods and wood-based panels

catalog page 4-4

Ø D [mm]	L2 [mm]	Ø d [mm]	L3 [mm]	L1 [mm]		Order-No. [L]	Order-No. [R]
3,0	27	10	30	70		50600588	50600376
4,0	25	10	24	70		50600451	50600450
5,0	35	10	24	70		50600590	50600378
6,0	35	10	50	100	for Lamello Clamex P®		50600380
8,0	40	10	22	70		50600591	50600379

2040 HW Dowel Bits with special tooth geometry



Drawing

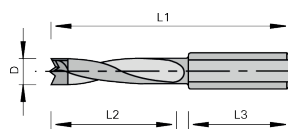

Machine



Application



ADVANTAGES

- ✓ chip-free hole edges
- ✓ safe & precise thanks to centering point
- ✓ up to 6-times longer edge-life (compared to traditional ones)
- ✓ wear-resistant HW plunging tip

Machine / Application

- portable and automatic boring machines
- CNC machining centers
- for chip-free drilling of dowel holes in solid woods and wood-based panels

Design

- special cutting edge geometry
- 2 spurs
- centering point
- HW-tipped

catalog page 4-8

Ø D [mm]	L2 [mm]	Ø d [mm]	L3 [mm]	L1 [mm]		Order-No. [L]	Order-No. [R]
5,0	35	10	30	70		50600648	50600649
6,0	35	10	30	70		50600650	50600651
8,0	35	10	30	70		50600652	50600652
10	35	10	30	70		50600654	50600655

CNC Combi Saw Blade Adapters HSK 63F

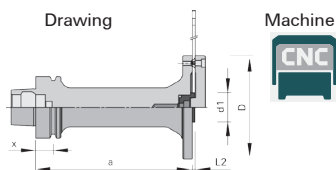
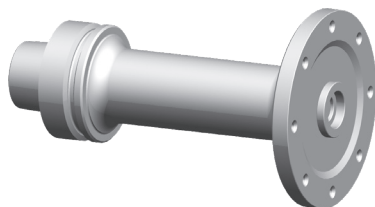

ADVANTAGES

- ✓ exchangeable centering adapter: one device for more sawblades (with different bore)
- ✓ flexible mounting of the sawblade (with and without lid)
- ✓ adapter with different length (a) available

Machine / Application

- CNC machining centers with automatic tool changer
- for precise mounting of circular saw blades

Notes

- for clockwise and counter-clockwise rotation
- Option: direct mounting by countersunk screws or with lid and cylindrical screws
- included: lid, countersunk- and cylindrical screws, centering adapter for sawblades with bore 30mm
- Attention: for Dmax. please ask our team for technical advice!

Design

- interface HSK 63 F (DIN 69893) for high-precise connection to the spindle

catalog page 5-3

Ø D [mm]	Ø d1max [mm]	Ø d [mm]	L2 [mm]	a [mm]	x [mm]	NL	Order-No.
106	30	HSK 63F	2,5	50	18	8/ M5/ 90	184836
106	30	HSK 63F	2,5	130	18	8/ M5/ 90	184838

Adapters with cylindrical shank

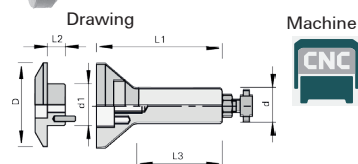
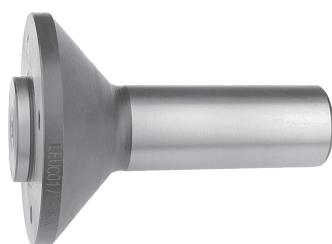

Machine / Application

- CNC Centers
- for Hydro Clamping System and draw-in collet chucks
- to mount circular saw blades and grooving cutters

Design

- secured against rotation with drive pin

Notes

- for clockwise and counter-clockwise rotation
- available in clamping length L2 = 30 & 36 mm: for single and multi-part milling tools
- Clamping length L2 = 4 & 5mm: for Sawblades and grooving cutters
- included: clamping arbor & flange, cap & length adjusting screw; for Ø 16 (172115), for Ø 25 (172113)

catalog page 5-1

Ø D [mm]	Ø d [mm]	Ø d1 [mm]	L2 [mm]	L1 [mm]	L2 [mm]	NL	Order-No.
60	16	30	4,0	80	60	4/ M6/ 48 Lamello Clamex P®	171394
60	25	30	4,0	90	70	4/ M6/ 48 Lamello Clamex P®	167826

Hydro Clamping Chucks ps-System with HSK 63F shank

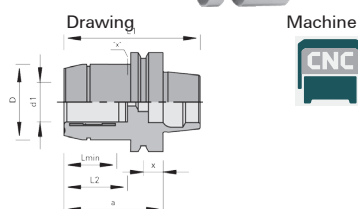

ADVANTAGES

- ✓ modularity & flexibility with "Reducing Bushings" (page 5-17)
- ✓ minimized setup-times
- ✓ easy and quick tool change
- ✓ high cutting quality, long edge lives and optimized torque transfer thanks to high concentricity

Machine / Application

- CNC centers with aut. tool charger
- for precise clamping of shank-type tools with cylindrical shank

Design

- n max = 30.000 min⁻¹
- interface DIN 69893 HSK 63 F
- for clockwise and counter-clockwise rotation
- includes bore for micro chip installation, for electronic tool detection

catalog page 5-16

Ø d1 [mm]	Lmin [mm]	L2 [mm]	Ø d [mm]	Ø D [mm]	L1 [mm]	a [mm]	x [mm]	Order-No.
16	39	49	HSK 63F	38	105	80	18	184307
25	47	57	HSK 63F	52,5	109	94	18	184309

Your Stehle Distribution Partner.

Please find the extended product range of CNC Tools & Sawblades at the Stehle Catalog 2020, available online: www.stehle-int.com.

Ask our certified international distribution partners for support.